

READY TO GO PEUGEOT PARTNER



EXTERIOR

Remote control



Unlocking



Locking

Sliding side door



From the outside

Pull the handle towards you then towards the rear and open the side door, guiding the rearward movement to beyond the point of resistance to hold it open.

Take care not to block the guide space on the floor to allow the door to slide correctly.

If your vehicle is parked on a slope, guide the sliding of the side door. In fact, the door could open or close more rapidly due to the slope of the ground and could cause injury.

Hinged rear doors



The hinged rear doors are asymmetrical (2/3 - 1/3), with the smaller door on the right. They are fitted with a central lock.

From outside

To open, pull the handle towards you.

Pull the lever to open the right-hand door.

To close, start with the right-hand door then close the left-hand door.



Opening to approximately 180°

A check strap system permits extension of the opening from approximately 90° to approximately 180°.

Pull the yellow control when the door is open.

The check strap will engage again automatically on closing.

Rear roof flap



To open the rear roof flap:

- raise the black paddle of the toggle,
- relieve the toggle by pressing the rear roof flap (downwards) then release the hook,
- lift the rear roof flap,
- pass the point of resistance to secure the rear roof flap using the support stays.

Tailgate



Opening

To open, press the control below the trim then raise the tailgate.

A pull strap is available to close the tailgate from the high position.

Guide the closing of the tailgate to the balance point of its travel then push on the tailgate to close it fully.

Refuelling



SP95
E10

SP98

DIESEL

- Open the fuel filler flap.
- Insert the key, then turn it a quarter turn.
- Remove the cap and hook it onto the clip located on the inside of the flap.

The capacity of the fuel tank is approximately 60 litres.

INTERIOR

Front seats



Seat backrest angle

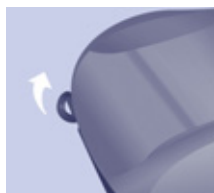

Seat height (driver)



Forwards/backwards



Steering wheel adjustment



When the vehicle is stationary, release the steering wheel adjustment mechanism by pulling the lever.

Adjust the steering wheel for height and reach, then lock the mechanism by pushing the lever fully forward.

Adjusting electric door mirrors



- Move the control to the right or to the left to select the corresponding mirror.
- Move the control in all four directions to adjust.
- Return the control to the central position.

Lighting

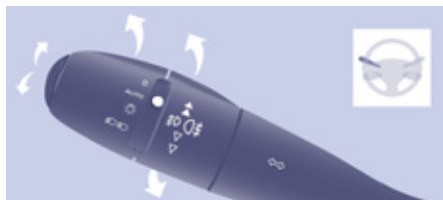

	Lighting off
AUTO	Automatic illumination of headlamps
	Sidelamps
	Dipped beam (green)
	Main beam (blue)
	Front foglamps (green, 1st rotation of the ring forwards).
	Rear foglamps (amber, 2nd rotation of the ring forwards).

Wipers

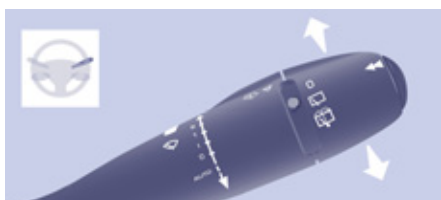

- 2** Fast wipe (heavy rain).
- 1** Normal wipe (moderate rain).
- I** Intermittent wipe.
- 0** Off.
- ↓** Single wipe (press downwards).

Automatic wipers



Do not cover the rain sensor, located in the centre of the windscreen, behind the mirror.

Rear wiper



Turn the ring to the first position.

Rear screenwash



Turn the ring past the first position: the rear screenwash then the rear wiper operates for a fixed time.

Electric windows



1. Driver's side
2. Passenger's side



Corresponds to a left hand drive vehicle.



Corresponds to a right hand drive vehicle.

Front airbags

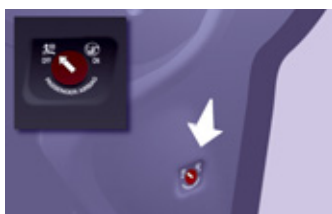

Deactivating the passengers front airbag

Only the passenger's front airbag can be deactivated.

- **With the ignition switched off**, insert the key into the passenger's front airbag deactivation switch.
- Turn it to the **"OFF"** position.
- Remove the key keeping the switch in the new position.

Recommended settings for air conditioning

If I require...	Air distribution	Temperature	Air flow	Air recirculation	A/C
Heating					-
Cooling					A/C
Demisting Defrosting					
<div>AUTO</div> <p>With automatic digital air conditioning, operation in AUTO mode is recommended, irrespective of the requirement.</p>					
<div></div> <p>Remember to switch it off when the ambient air suits your requirements.</p>					



Demisting the rear screen and/or mirrors

Parking brake



Applying

Pull the parking brake lever up to immobilise your vehicle.

Check that the parking brake is applied firmly before leaving the vehicle.

Releasing

Pull the lever up slightly and press the button to lower the parking brake lever.

Manual gearbox



5-speed

6-speed

Engaging reverse gear

To engage reverse gear, wait until the vehicle has come to a complete stop.

In the 6-speed configuration, raise the collar below the gear knob.

Changing into 5th or 6th gear

To engage the gear correctly, move the gear lever fully to the right.

6-speed electronic gearbox



Moving off

- To start the engine, the gear selector must be in position **N**.
- Press firmly on the brake pedal.
- Operate the starter.
- When the engine is running, place the gear selector on **R**, **A** or **M** as desired.
- Release the brake pedal and accelerate.

Manual mode



Move the gear selector to **M**.



Pull on the "+" control paddle to change up.

Pull on the "-" control paddle to change down.

Multi-Flex bench seat



Mobile office position

Pull the tab located on the lower edge of the seat to lower the seat back incorporating a writing table equipped with a strap.

To return the seat back to the upright position, pull the tab and guide the seat backrest until it locks.

During the operations, take care not to trap the tab under the seat cushion.



Foldaway position

Raise the yellow lever located at the base of the seat to release and raise the entire seat to the foldaway position (seat cushion raised against the seat backrest) until it locks.

This position allows tall loads to be carried in the cab part.

To return the seat to the seat position, push the yellow lever located under the seat cushion and lower the entire seat until it is upright and locked on the floor in the seat position.

Outer seat



Fully folded position

Pull the tab located on the upper edge of the seat by the head restraint to tilt and guide the entire seat.

It inserts itself into the floor in the front seat position and so forms a continuous flat floor with the load space.

This position allows long loads to be carried inside the vehicle, up to 3 m (3.25 m in the case of the long versions) with the doors closed.

In the fully folded position, the maximum weight on the seat backrest is 50 kg.

To return the seat to the seat position, raise the seat backrest until it locks on the floor in the seat position.

Passenger seat

The backrest of the individual passenger seat can be folded to allow very long objects to be carried.

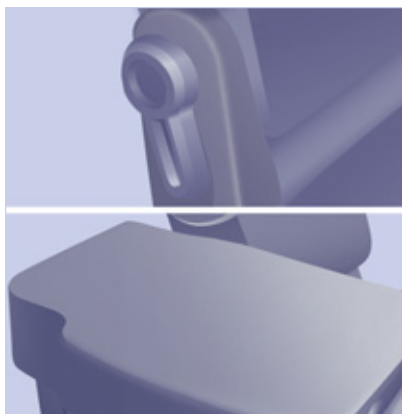

Folding the seat backrest

Pull the lever forwards then tilt the seat backrest.

Returning the seat backrest to its original position

Pull the lever forwards then raise the seat backrest until it locks.

Crew cab

Bench seat



Placing in the fully folded position

- If necessary, move the front seats forward and fasten the strap of the seat belt of the centre seat.
- Check that the seat belt straps and buckles are positioned correctly along the side panels, to ensure that the sliding of the seat backrest is not hindered.
- Release the seat backrest using the control **A**.



- Using the same hand, fold the seat backrest and the associated grille onto the seat cushion.



- Take hold of the red strap (like a handle) and lift the assembly vertically, guiding the movement to the fully folded position.

The raised seat rests against the backrests of the seats of row 1.

Returning to the seat position

- In a single movement: take hold of the red strap and pull the assembly horizontally towards the rear. Guide the movement until the feet of the bench seat lock on the floor.
- Raise the seat backrest. The control **A** locks in place automatically.
- Check that the bench is locked on the floor correctly once it has been returned to the seat position.

Do not let the assembly fall sharply.

7-inch touch screen



Use the buttons above the touch screen for access to the menu carousel, then press the virtual buttons in the touch screen.

Each menu is displayed in one or two pages (primary page and secondary page).

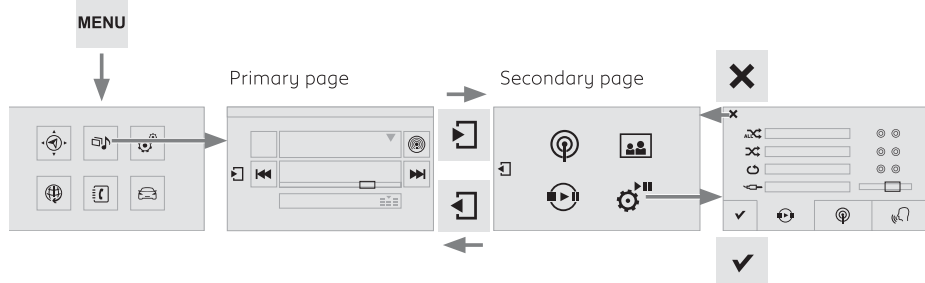

Menus



Navigation

(Depending on equipment)



Enter navigation settings and choose a destination.



Connected services

(Depending on equipment)

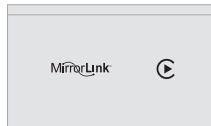

Operate certain applications on your smartphone via MirrorLink™ or CarPlay®.



Radio Media



Select an audio source, a radio station, display photographs.



Telephone



Connect a telephone by Bluetooth®. Access to the CarPlay® function after connection of your smartphone by USB cable.



Settings

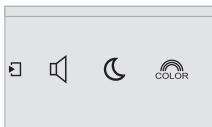

Adjust the settings for sound (balance, ambience, ...), colour schemes and the display (language, units, date, time, ...).



Driving

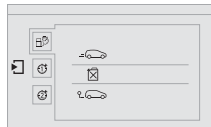

Access to the trip computer. Activate, deactivate or enter settings for certain vehicle functions.

7-inch touch screen

MirrorLink™

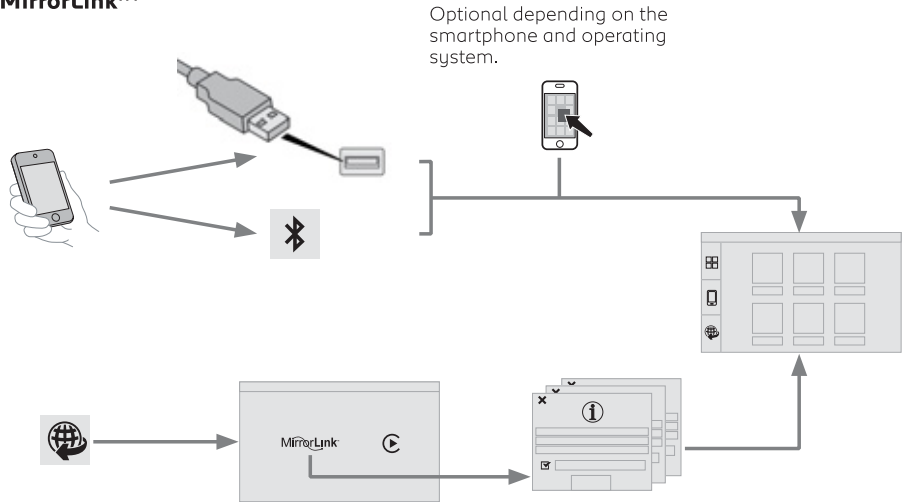

The synchronisation of a smartphone allows applications on a smartphone that are adapted to the MirrorLink™ technology to be displayed in the vehicle's screen.

The principles and standards are constantly evolving. For the communication process between the smartphone and the system to work correctly, the smartphone must be unlocked ; update the operating system of your smartphone as well as the date and time in the smartphone and the system.

For the list of eligible smartphones, connect to the brand's internet website in your country.

CarPlay®

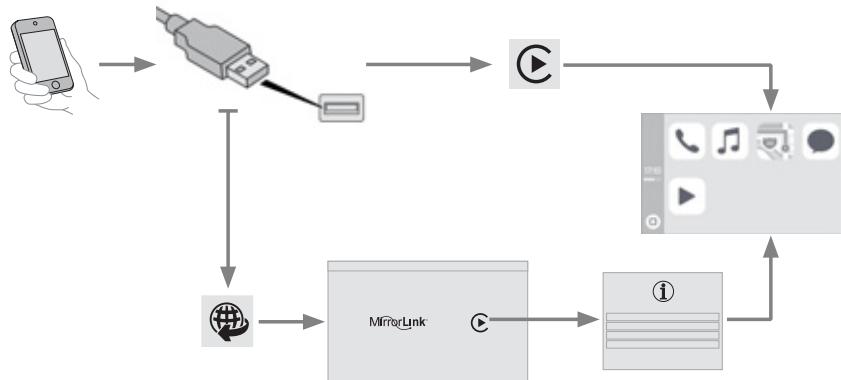

The synchronisation of a smartphone allows applications on a smartphone that are adapted to the CarPlay® technology to be displayed on the vehicle's screen.

As the principles and standards are constantly evolving, it is recommended that you update the operating system of your smartphone.

For the list of eligible smartphones, connect to the brand's internet website in your country.

Peugeot Connect Sound (RD5)



On / Off, volume setting.



Eject CD.



Select the screen display mode :
Date, audio functions, trip computer,
telephone.



The DARK button changes the screen
display for improved driving comfort at
night.

1st press : upper bar only illuminated.

2nd press : black screen.

3rd press : return to standard display.



Select source :
Radio ; USB ; AUX ; CD ; Streaming.



Select AM / FM wavebands.



Audio settings :
Front/rear fader, left/right balance, bass/
treble, loudness, audio ambiances.



Display the list of local stations.
Long press : CD tracks or MP3 folders
(CD / USB).



TA (Traffic Announcements) on/off.
Long press : PTY * (radio Programme
TYpe).

* Available according to version.



Abandon the current operation.



Display main menu.



Select next frequency down/up.
Select previous/next MP3 folder.
Select previous/next folder / genre / artist /
playlist (USB).



Automatic frequency search down/up.
Select previous/next CD, MP3 or USB
track.



Confirm.



Buttons 1 to 6
Select a pre-set radio station.
Long press : pre-set a station.

Steering mounted controls



Change audio source.
Confirm a selection.
Call/end call on the telephone.
Press for more than 2 seconds : telephone main menu.



Mute: press the volume increase and decrease buttons simultaneously.
The sound is restored by pressing one of the two volume buttons.



Radio: select the previous/next pre-set station.
USB: select genre / artist / folder from the classification list.
Select the previous/next item in a menu.



Radio: automatic search for a higher frequency.
CD / MP3 / USB: select the next track.
CD / USB: continuous press: fast forward.
Move in the list.



Radio: automatic search for a lower frequency.
CD / MP3 / USB: select the previous track.
CD / USB: continuous press: rewind.
Move in the list.



Volume increase.



Volume decrease.

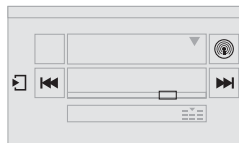

Radio: select the previous/next preset station.

Media : select a genre / artist / folder from the list.

Select the previous/next entry in a menu.



Radio: automatic search for a higher frequency.

Media: Select next track.

Media, press and hold: fast forward.
Jump in the list.



Radio: automatic search for a lower frequency.

Media: select previous track.

Media, press and hold: fast back.
Jump in the list.

Date and time



Screen C

Press the **MENU** button.

Using the arrows, select **PERSONALISATION CONFIGURATION**.



Press to confirm the selection.

Using the arrows, select **DISPLAY CONFIGURATION**.



Press to confirm the selection.

Using the arrows, select **ADJUST DATE AND TIME**.



Press to confirm the selection.

Adjust the settings one by one confirming by pressing the **OK** button.



Then select the OK tab in the screen and confirm.

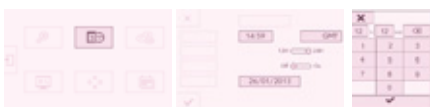

Touch screen



Select the "**Configuration**" menu.



In the secondary page, press on "**Time/Date**".

Select "**Adjust time**" or "**Adjust date**" and modify the settings using the number keypad, then confirm.



Press "**Confirm**" to quit.

Driving on flooded roads

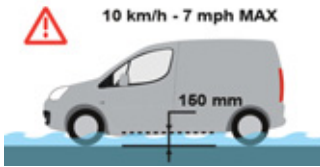

Gear shift indicator



System which reduces fuel consumption by recommending the most appropriate gear.

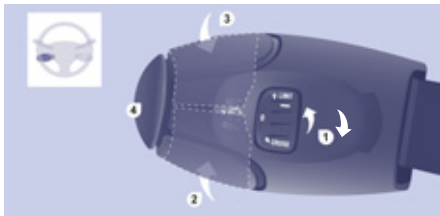

Speed limiter "LIMIT"



1. Limiter mode On / Off.
2. Reduce programmed speed setting.
3. Increase programmed speed setting.
4. Speed limiter On / Pause.

Cruise control "CRUISE"



1. Cruise control mode On / Off.
2. Reduce cruise speed setting.
3. Increase cruise speed setting.
4. Pause / Resume cruise control.

Active City Brake

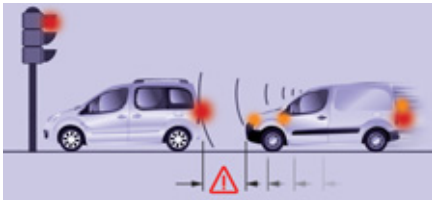

Active City Brake is a driving assistance system that aims to avoid a frontal collision or reduce the speed of an impact if the driver does not react sufficiently (inadequate brake application).

Grip control



Different **modes** are available :



Normal (ESC)



Snow



**Off road
(mud, wet grass, ...)**



Sand



ESC OFF

Under-inflation detection

This system continuously monitors the pressures of the four tyres, as soon as the vehicle is moving. A pressure sensor is located in the valve of each tyre (except the spare wheel).



The system triggers an alert if a drop in pressure is detected in one or more tyres.

Parking sensors



The audible (front and rear) and visual (rear) parking sensor system consists of proximity sensors, installed in the rear bumper.

An audible signal confirms the activation of the system by engaging reverse gear.

The proximity information is indicated by an audible signal which becomes more rapid as the vehicle approaches the obstacle.



You can activate or deactivate the system by pressing this button.

Reversing camera

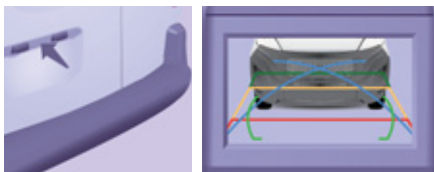

The reversing camera is activated automatically when reverse gear is engaged.

The blue lines represent the general direction of the vehicle (the difference corresponds to the width of your vehicle without the mirrors).

The red lines represent a distance of about 30 cm beyond the edge of your vehicle's rear bumper.

The green lines represent distances of about 1 and 2 metres beyond the edge of your vehicle's rear bumper.

The turquoise blue curves represent the maximum turning circle.

ENGINES



Stop & Start

The Stop & Start system puts the engine temporarily on standby - STOP mode - during stops in the traffic (red lights, traffic jams, or other...). The engine restarts automatically - START mode - as soon as you want to move off. The restart takes place instantly, quickly and silently.



At any time, press the "**ECO OFF**" switch to deactivate the system.

BlueHDi and AdBlue®



BlueHDi vehicles have a specific AdBlue® additive tank with a **capacity of 17 litres**.

It has an exterior filler with a **blue filler cap**, located to the left of the Diesel fuel filler cap.



Filling of the AdBlue® tank can be done using 5 or 10 litre containers, 1.89 litre bottles, or when at a fuel filling station equipped with a special AdBlue® delivery pump for light vehicles.

Your vehicle will be fitted with only some of the equipment described in this document, depending on its trim level, version and the specification for the country in which it was sold.

This document is not a substitute for the detailed study of the handbook.



ANG.16PAR.P641