

READY TO GO PEUGEOT TRAVELLER



EXTERIOR

Key, remote control



"Keyless Entry and Starting" Remote control



Unlocking Using the remote control



To unlock the vehicle, press this button.

Using the remote control with electric sliding side door(s)



To unlock the vehicle and open the side door, press and hold this button until the door has opened.

"Keyless Entry and Starting" on your person



Unlocking



To unlock the vehicle, remote control on your person and in the recognition zone **A**, pass your hand behind one of the door handles (front doors, manual sliding side doors and side-hinged doors).

Pull the handle to open the corresponding door.

With electric sliding side door(s)



To unlock the vehicle, remote control on your person and in the recognition zone **A**, pull and release the door

handle to trigger the electric powered opening of the corresponding door.

With a tailgate



To unlock the vehicle, remote control on your person and in the recognition zone **A**, pull the tailgate handle.

Raise the tailgate.

With an opening rear screen in the tailgate



To unlock the vehicle, remote control on your person and in the recognition zone **A**, press the unlocking button for the tailgate.

The screen partly opens.

Manual sliding side door(s)



After unlocking the vehicle (using the key, remote control or Keyless Entry and Starting, depending on equipment) pull the door handle.

Electric sliding side door(s)



Door unlocked, pull and release the handle to start the electrically powered opening of the door.
Pull the handle again to reverse the movement of the door.

Hands-free sliding side door(s)

By keeping the remote control on your person and with a movement of your foot, the system unlocks and opens the sliding side door or closes and locks it.

The remote control must be located at the rear of the vehicle, more than about 30 cm and less than about 2 m from the vehicle.



Opening

With "Hands-free access" activated in the vehicle configuration menu.

- With the remote control on your person and in the recognition zone A, pass your foot under the outer rear bumper, on the side you want to open the door.

Closing

With "Hands-free access" activated in the vehicle configuration menu.

- With the remote control on your person and in the recognition zone A, pass your foot under the outer rear bumper, on the side you want to close the door.

Side-hinged rear doors

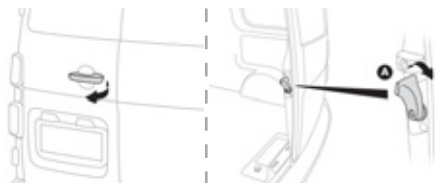

- After unlocking the vehicle (using the key, remote control or Keyless Entry and Starting, depending on equipment) pull the door handle.
- After first opening the left-hand door, pull the lever A towards you to open the right-hand door.

Opening to approximately 180°



- Pull the yellow control when the door is open. The check strap will engage again automatically on closing.

Locking

Using the remote control



- To lock the vehicle totally, press this button.

"Keyless Entry and Starting" on your person



With side-hinged doors

- To **totally** lock the vehicle, with the remote control in the recognition zone A, press with a finger or thumb at the markings on one of the front or manual sliding side door handles.

With a tailgate



- To lock the vehicle, with the remote control in the recognition zone A, press the tailgate locking control.

Bonnet

Opening

- Open the door.



- Pull the release lever, located at the bottom of the door aperture, towards you.
- Lift the safety catch, then raise the bonnet.

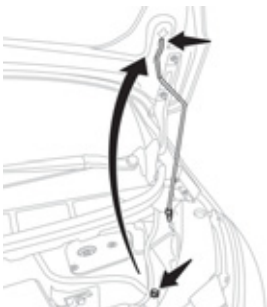

- Unclip the stay from its housing and place it in the support slot to hold the bonnet open.

INTERIOR

2-seat front bench seat

Under-seat storage



- ☞ Pull the strap to tip the seat.

Fixed one-piece bench seat

Folding the seat backrest to the table position

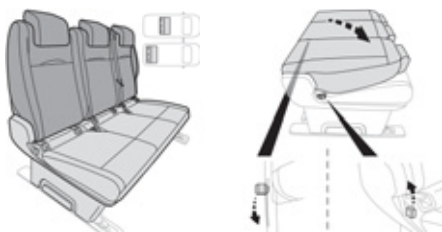

- ☞ Place the head restraints in the low position
- ☞ From the front, raise the handle to release the seat backrest.
- ☞ From the rear, lower the handle to release the seat backrest..
- ☞ Fold the backrest onto the seat cushion.
- ☞ To return the backrest to its normal position, raise the handle and pull the backrest up.

Tipping, access to row 3

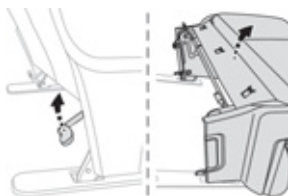

- ☞ Using the handle, release the rear feet then tip the seat forward.
- ☞ To return the seat, tip the bench towards the rear until the feet lock into place..

Fixed rear seat and bench seat

Folding the backrest to the table position

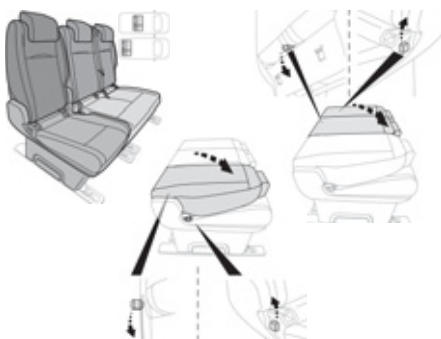

- ☞ Put the head restraints into the low position.
- ☞ From the front, raise the handle to release the backrest.
- ☞ From the rear, lower the lever to release the backrest.
- ☞ Fold the backrest onto the cushion.
- ☞ To return the backrest to the normal position, raise the lever and pull the backrest up (from the rear, lower the lever).

Fully folding a seat, access to row 3

(example of an individual seat)

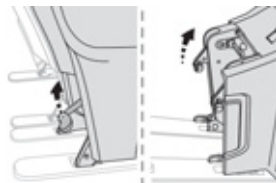

- ☞ Using the handle, release the rear feet then tip the seat forward.
- ☞ To return the seat to the normal position, unfold the seat backwards until the rear feet engage in their anchorages.

Rear seat and bench seat on rails

Folding the seat backrest to the table position

(example of an individual seat)

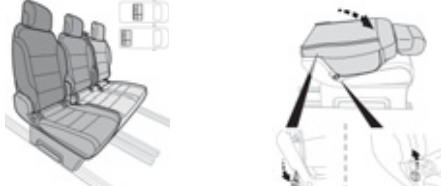

- ☞ Place the head restraints in the low position.
- ☞ From the front, raise the handle to release the backrest.
- ☞ From the rear, lower the handle to release the backrest.
- ☞ Fold the backrest onto the cushion.

Return the backrest to the normal position (between the markings)

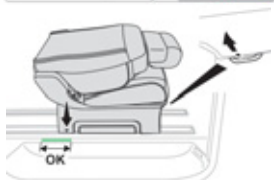

To return the backrest to the normal position, the seat must be positioned between the markings. The arrow must not be outside the markings.

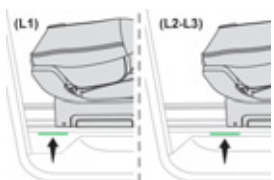

Use the front control to move the seat so that it is between the markings.

Moving forward or backward

(example of an individual seat)



Two controls are provided for moving the seat forwards and backwards:

- From the front, raise the control and slide the seat forward or back.
- From the rear, pull the strap without going beyond the point of resistance and push the seat forward or pull it back.

Individual seat(s) on rails

Folding the seat backrest to the table position

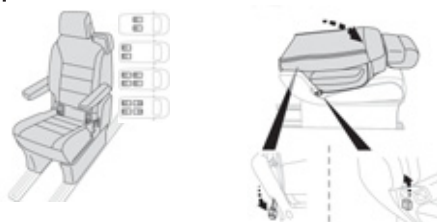

- Place the head restraints in the low position.
- From the front, raise the handle to release the backrest.
- From the rear, lower the handle to release the backrest.
- Fold the backrest onto the cushion.

Moving forward or backward



Two controls are provided for moving the seat forward and backward:

- From the front, raise the control and slide the seat forward or back.
- From the rear, pull the strap without going beyond the point of resistance and push the seat forward or pull it back.

Deactivating the passenger's front airbag

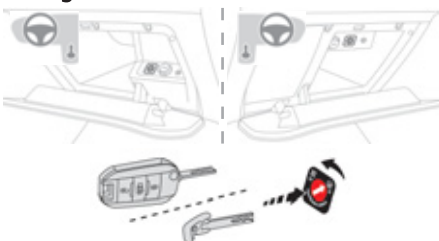

- With the ignition off**, insert the key in the passenger airbag deactivation switch.
- Turn it to the **"OFF"** position.
- Remove the key keeping the switch in the new position.



When the ignition is on, this warning lamp comes in the seat belt warning display screen. It stays on while the airbag is deactivated.

Folding and sliding table

Moving forward or backward

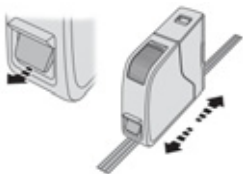

- ☞ Raise this control (without going beyond the point of resistance) and slide the assembly forward or backward.
- ☞ Release the control when it is in the desired position.
- ☞ Check that the table is correctly latched on the runner. If this is not the case, move the assembly slightly to the next notch on the runner.

Unfolding



- ☞ Operate the control on the top and pull the table assembly up until it clicks into place.

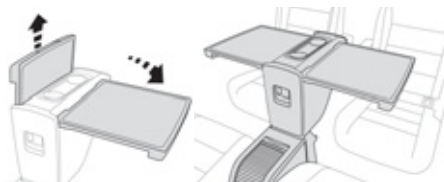

- ☞ Pull each table top fully up then pivot them on each side into the horizontal position.

Manual child lock



Locking



- ☞ Turn the control on the edge of the side door upwards.

Unlocking



- ☞ Turn the control on the edge of the side door downwards.

Electric child lock



Switching on

- ☞ With the ignition on, press this button. The indicator lamp in the button comes on, accompanied by a message to confirm that the child lock is on.
- This indicator lamp remains on until the child lock is switched off.
- It is still possible to open the doors from the outside.

Electric front seat

Forwards-backwards

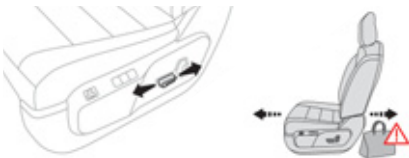

Backrest angle



Height

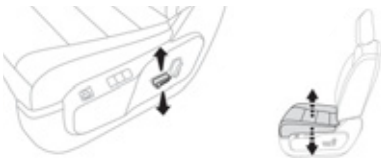

Steering wheel adjustment



- ☞ **When stationary**, lower the control lever to release the steering wheel adjustment mechanism.
- ☞ Adjust the height and reach to suit your driving position.
- ☞ Pull the control lever to lock the steering wheel adjustment mechanism.

Lighting control stalk

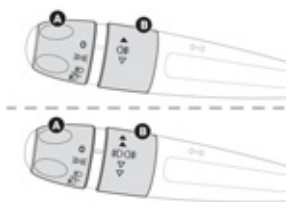

Ring A

- Lighting off / daytime running lamps.
- AUTO** Automatic illumination of headlamps.
- Sidelamps.
- Dipped / main beam headlamps.

Ring B

- Rear foglamp only.
- Front and rear foglamps.

Wiper control stalk

Windscreen wipers



- 2** Fast wipe (heavy rain).
- 1** Normal wipe (moderate rain).
- Int** Intermittent wipe (proportional to the speed of the vehicle).
- Park** Park.
- Single wipe (press downwards or pull the stalk briefly towards you, then release).

or

- AUTO** Automatic wiping (press down, then release).
- Single wipe (pull the stalk briefly towards you).

Automatic rain sensitive windscreen wipers

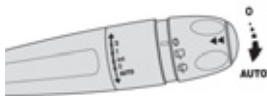

Switching on

Briefly push the control stalk downwards.

Switching off

Briefly push the control stalk downwards again, or place the control stalk in another position (Int, 1 or 2).

Rear wiper



- Park.
- Intermittent wipe.
- Wash-wipe (set duration).

PEUGEOT Connect Nav

PEUGEOT Connect Radio

Depending on equipment.



- Adjust volume/Mute. On/Off.

Use the buttons on either side of the touch screen for access to the menus, then press the virtual buttons in the touch screen.

- Use this button to confirm.
- Use this button to quit.

Menus

- Driving**
Activate, deactivate, adjust the settings for certain vehicle functions.

- Radio Media**
Select an audio source, a radio station, display photographs.

- Connected navigation**
Depending on equipment.
Enter navigation settings and choose a destination.
Use services available in real time, depending on equipment.

- Settings**
Enter settings for a personal profile and/or adjust the settings for sound (balance, ambience, ...), and the display (language, units, date, time, ...).

- Connectivity**
Operate certain applications on a smartphone connected via MirrorLink™ or CarPlay®.
Check the state of Bluetooth and Wi-Fi connections.

- Telephone**
Connect a telephone by Bluetooth®, read messages and emails and send quick messages.

- Voice commands**
Depending on equipment.
Pressing this button activates the voice commands function.

Bluetooth® audio system

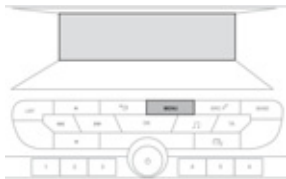

Press: On / Off
Rotate: adjust volume.

MENU

Access to main menu.

SRC /

Short press: change audio source (Radio; USB; AUX (if a device is connected); CD; Streaming).

Long press: display the telephone menu (if a telephone is connected).



Adjust audio settings:
Front/rear fader; left/right balance; bass/treble; loudness; audio ambience.
Activation / deactivation of automatic volume adjustment (linked to the speed of the vehicle).

LIST

Radio:

Short press: display the list of radio stations.

Long press: update the list.

Media:

Short press: display the list of folders.

Long press: display the sorting options.



Select the screen display mode, between: Date; Audio functions; Trip computer; Telephone.

OK

Confirm or display contextual menu.

1

Buttons 1 to 6.

Short press: select the preset radio station.

Long press: preset a station.



Radio:

Automatic step by step search up / down for radio stations.

Media:

Select previous / next CD, USB, streaming track.

Scroll in a list.



Radio:

Manual step by step search up / down for radio stations.

Select previous / next MP3 track.

Media:

Select previous / next folder / genre / artist / playlist on the USB device.

Scroll in a list.



Abandon the current operation.
Go up one level (menu or folder).

TA

Activate / Deactivate TA (traffic announcements)

Long press: select type of announcement.

BAND

Select waveband: FM / DAB / AM.

12 V accessory socket(s)

(depending on version)

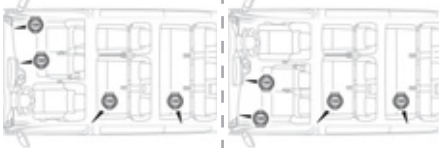

To connect a 12 V accessory (maximum power: 120 Watts), lift the cover and connect a suitable adaptor.

USB port

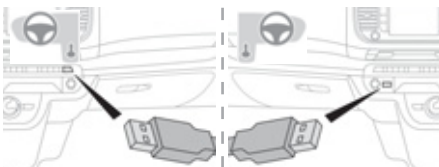

It allows the connection of a portable device, such as a digital audio player of the iPod® type or a USB memory stick.

Tool box



The tool box is located under the left-hand front seat.

Removing



Press the latches **A** and slide them inwards to release the box.

Lift the box slightly then pull it as far as it will go to take it past bar **1**.



Then, lift the box upwards to take it past bar **2**.



Unclip the fixings **B** on the cover, then open it for access to the tools.

Manual air conditioning



Air flow



☞ Turn the knob to obtain a comfortable air flow.

Temperature



☞ Turn the knob from "LO" (cold) to "HI" (hot) to adjust the temperature to your requirements.

Air distribution



Windscreen and side windows.



Central and side vents.



Footwells.

Air intake / Air recirculation



☞ Press this button to recirculate the interior air; its indicator lamp comes on.

Air conditioning



☞ Press this button; its indicator lamp comes on.



Front demist - defrost



Door mirrors demist - defrost



Rear screen demist - defrost

Dual-zone automatic air conditioning



Temperature



☞ Push the button down to reduce the value or up to increase it.

Automatic comfort mode



☞ Press the "AUTO" button repeatedly.

"Mono" function

The comfort setting for the passenger side can be indexed to the driver's comfort setting (mono-zone).



☞ Press this button to activate / deactivate the "Mono" function.

Visibility programme



☞ Press the "visibility" button for faster demisting or defrosting of the windscreen and side windows.

Air conditioning



☞ Press this button; its indicator lamp comes on.

Air distribution



☞ Press this button repeatedly to direct the air flow in turn to:

- the windscreen, the side windows and the footwells,
- the footwells.
- the central vents, the side vents and the footwells,
- the windscreen, the side windows, the centre vents and the footwells,
- the centre and side vents,
- the windscreen and side windows (demisting or defrosting),

Air flow



☞ Press this button to increase air flow.



☞ Press this button to decrease air flow.

Air intake / Air recirculation



☞ Press this button to recirculate the interior air; the symbol appears.

5-speed manual gearbox

Engaging reverse gear

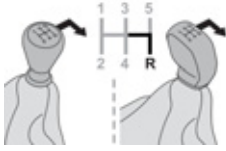

6-speed manual gearbox

Engaging reverse gear



Automatic gearbox

Gear selector

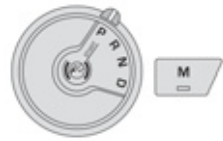

P. Park.

- ☞ With your foot on the brake, turn the selector to this position for parking or starting.

R. Reverse.

- ☞ Turn the selector to this position.

N. Neutral.

- ☞ Turn the selector to this position for starting.

D. Automatic operation.

- ☞ Turn the selector to this position.

M. Manual operation with sequential gear changing

- ☞ Selector in position **D**, press this button then use the steering mounted control paddles to change gear.

Steering mounted controls



- ☞ Pull the right hand "+" control paddle towards you to change up.
- ☞ Pull the left hand "-" control paddle towards you to change down.

Electronic gearbox

Gear selector



R. Reverse

- ☞ Turn the selector to this position.

N. Neutral.

- ☞ With your foot on the brake, turn the selector to this position for starting.

A. Automatic operation.

- ☞ Turn the selector to this position **A**.

M. Manual operation with sequential gear changing.

- ☞ Turn the selector to this position, then use the steering mounted control paddles to change gear.

Steering mounted control paddles



- ☞ Pull the right hand "+" control paddle towards you to change up.

- ☞ Pull the left hand "-" control paddle towards you to change up.

Starting-switching off the engine, manual key, remote control



The parking brake must be applied.

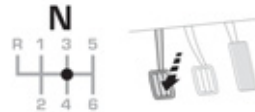

- ☞ If your vehicle has a manual gearbox, place the gear lever in neutral then fully depress the clutch pedal.



- ☞ If your vehicle has an automatic gearbox, place the selector at position **P** then press the brake pedal firmly.

/..



- ☞ If your vehicle has an electronic gearbox, place the selector at position **N** then press the brake pedal firmly.

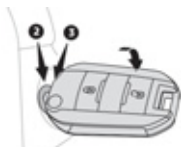

- ☞ Insert the key in the ignition switch. The system recognises the starting code.
- ☞ Unlock the steering column by simultaneously turning the steering wheel and the key.
- ☞ Turn the key to position 2, ignition on, to operate the engine pre-heating.

Starting-switching off the engine, "Keyless Entry and starting"

- ☞ Place the remote control inside the vehicle, in the recognition zone.



- ☞ If your vehicle has a manual gearbox, fully depress the clutch pedal until the engine starts.



- ☞ If your vehicle has an automatic gearbox, place the selector at position **P** then press the brake pedal firmly.



- ☞ If your vehicle has an electronic gearbox, place the selector at position **N** then press the brake pedal firmly.



- ☞ Then, press the "**START/STOP**" button.

The steering column unlocks and the engine starts more or less immediately.

Reversing camera with display in the interior mirror



The visual aid reversing camera is activated automatically when reverse gear is engaged.

180° rear vision



This system allows the rear surroundings of the vehicle to be viewed in the display screen using cameras located at the rear of the vehicle. The parking sensors in the rear and/or front bumper complete the information on the view from above the vehicle (right-hand part).

The blue outline represents the width of your vehicle (with mirrors): its orientation depends on the position of the steering wheel.

The red line represents a distance of 30 cm from the rear bumper and the two blue lines, 1 m and 2 m respectively.



"Standard view".



"Zoom view".



"180° view".



"AUTO mode".

Rear parking sensors



The system is switched on by engaging reverse gear.

Front parking sensors

As an addition to the rear parking sensors, the front parking sensors are triggered when an obstacle is detected in front and the speed of the vehicle is still below 6 mph (10 km/h).

Grip control



Standard (ESC)



Snow



All terrain (mud, damp grass, ...)



Sand



Speed limiter ("LIMIT")

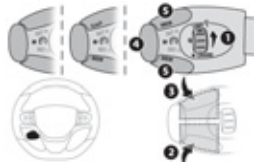

1. Select speed limiter mode.
2. Lower the programmed speed.
3. Raise the programmed speed.
4. Speed limiter on / pause.
5. If fitted to your vehicle, display the list of memorised speeds or memorise the speed suggested by the speed limit recognition system.

Switching on the speed limiter requires a programmed speed of at least 20 mph (30 km/h).

Cruise control ("CRUISE")

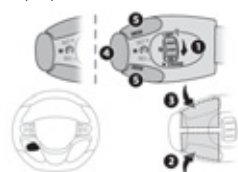

1. Select cruise control mode.
2. Programme a speed setting/Lower the speed setting.
3. Programme a speed setting/Raise the speed setting.
4. Pause-resume cruise control.
5. If fitted to your vehicle, display the list of memorised speeds or memorise the speed offered by the speed limit recognition system.

The cruise control is **switched on** manually: it requires a minimum vehicle speed of 25 mph (40 km/h).

Blind spot monitoring system

This driving assistance system warns the driver of the presence of another vehicle in the blind spot angle of their vehicle (areas masked from the driver's field of vision), as soon as this presents a potential danger.

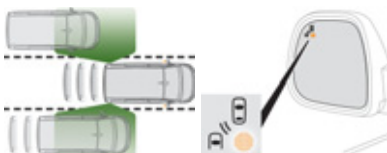

A warning lamp appears in the door mirror on the side in question:

- immediately, when being overtaken,
- after a delay of about one second, when overtaking a vehicle slowly.

Speed limit recognition



This system allows the speed limit detected by the camera to be displayed in the instrument panel.

Specific speed limits, such as those for heavy goods vehicles, are not displayed.

The display of the speed limit in the instrument panel is updated as you pass a speed limit sign intended for cars (light vehicles).

Collision Risk Alert and Active Safety Brake



The Collision Risk Alert system allows the driver to be warned that their vehicle is at risk of collision with the vehicle in front or a pedestrian in their traffic lane.



The Active Safety Brake system intervenes following the alert if the driver does not react quickly enough and does not operate the vehicle's brakes.

Lane departure warning system



System that uses a camera to recognise continuous or broken lines on traffic lanes and triggers an alert if the vehicle wanders off line.



You are alerted by the flashing of this warning lamp in the instrument panel, accompanied by an audible signal.

The system is particularly useful on motorways and fast roads.

Fatigue detection system

Driving time warning

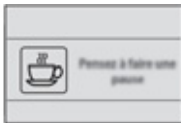

The system triggers an alert once it detects that the driver has not taken a break after two hours of driving at a speed above 40 mph (65 km/h).

This alert takes the form of the display of a message encouraging you to take a break, accompanied by an audible signal.

Fatigue detection system

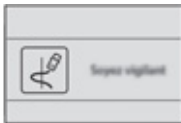

Using a camera placed at the top of the windscreen, the system assesses the driver's level of vigilance by identifying variations in trajectory compared to the lane markings.

Stop & Start

ECO Going into engine STOP mode

If your vehicle has a **manual gearbox**, its speed must be below 12 mph (20 km/h) or stationary (depending on engine); the "ECO" indicator lamp comes on in the instrument panel and the engine goes into standby automatically when you place the gear lever in neutral and you release the clutch pedal.

If your vehicle has an **automatic gearbox** and the vehicle is stationary, the "ECO" indicator lamp comes on and the engine goes into standby automatically when you press the brake pedal or place the gear selector in position **N**.

If your vehicle has an **electronic gearbox** and the vehicle's speed is below 5 mph (8km/h), the "ECO" indicator lamp comes on and the engine goes into standby automatically when you press the brake pedal or place the gear selector in position **N**.

ECO Going into engine START mode

If your vehicle has a **manual gearbox**, the "ECO" indicator lamp goes off in the instrument panel and the engine restarts automatically when you **fully** depress the clutch pedal.

If your vehicle has an **automatic gearbox**, the "ECO" lamp goes off in the instrument panel and the engine restarts automatically when:

- you release the brake pedal with the gear selector in position **D** or **M**,
- you are in position **N** with the brake pedal released and you move the gear selector to position **D** or **M**,
- you engage reverse.

If your vehicle has an **electronic gearbox**, the "ECO" lamp goes off in the instrument panel and the engine restarts automatically when:

- you release the brake pedal with the gear selector in position **A** ou **M**,
- you are in position **N** with the brake pedal released and you move the gear selector to position **A** or **M**,
- you enegage reverse.

Your vehicle will be fitted with only some of the equipment described in this document, depending on its trim level, version and the specification for the country in which it was sold.

This document is not a substitute for the detailed study of the handbook.

Fuel tank

Capacity of the tank: approximately **69** litres.

Opening

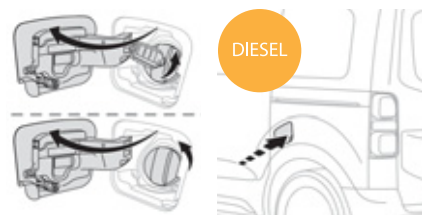

☞ **You must switch off the engine.**

- ☞ If your vehicle has Keyless Entry and Starting, unlock the vehicle.
- ☞ Open the filler flap.

AdBlue® and SCR system

The AdBlue® is held in a special tank with a capacity of about 22 litres: this provides a driving range of about 12 500 miles (20 000 km), after which an alert is triggered warning you when the reserve remaining is enough for just 1 500 miles (2 400 km).

- ☞ Switch off the ignition and remove the key, or if your vehicle has one, press the START/STOP button to switch off the engine.

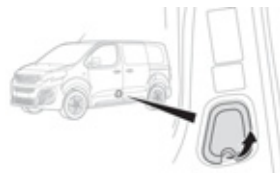

- ☞ For access to the AdBlue® tank, open the left-hand front door.
- ☞ From below, pull the black cover.

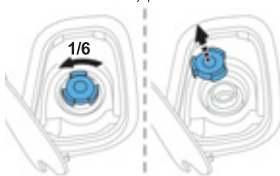

- ☞ Turn the blue cap a 6th of a turn anti-clockwise.
- ☞ Lift off the cap.



ANG.16K0P.P040

